



Attention

1. Before turning on the power, please ensure that all connections are correct and secure, and do not operate while the power is on.
2. The product should be used under the rated voltage. Using it under excessive or insufficient voltage may cause damage.
3. Do not disassemble the product, as it may cause fire and electric shock.
4. Do not use the product in environments exposed to direct sunlight, moisture, high temperatures, etc.
5. Do not use the product in metal shielded areas or around strong magnetic fields, as this may severely affect the wireless signal transmission of the product.

Disclaimers

1. Our company will update the content of this manual based on the improvement of product functionality. The updates will be displayed in the latest version of this manual, without further notice.
2. Due to our continuous adoption of new technologies, product specifications may change without further notice.
3. This manual is provided for reference and guidance only and does not guarantee complete consistency with the actual product. The actual application should be based on the actual product.
4. The components and accessories described in this manual do not represent the standard configuration of the product. The specific configuration is subject to the packaging.
5. All text, tables, and images in this manual are protected by relevant national laws and may not be used without our permission.
6. This product may be compatible with third-party products (such as apps, hubs, etc.), but our company does not take responsibility for compatibility issues or partial loss of functionality caused by changes in third-party products.



LED-Trading Tobias Ebert

Schoeneicher Str. 42, Schoeneiche b. Berlin, Germany, 15566

0049 30 641 689 17 info@led-trading.de

GL-RC-I-001WL



GLEDOPTO

WLED Remote control

User Instruction

GL-RC-001WL

封底

封面

1. Product Display



2. Product Parameter

Model No.: GL-RC-001WL	Input Voltage: 3V
Standby Current: <13uA	Battery Type: 1.5V(2*AAA Battery)
Control Distance: 50m	Wireless Communication Method: WiFi
Material: PC	Waterproof Rating: IP20
Working Temperature: -20~45°C	Size: 39x16x143mm

3. Button Functions

- 1) ON: Turn on.
- 2) OFF: Turn off.
- 3) S1~S4: Short press to preset (preset needs manual setting, refer to "5. Preset Scenes" for setting steps).
- 4) Indicator light: Short press to enter night light mode, brightness decreases to the lowest.
- 5) Brightness +: Short press to increase brightness.
- 6) Brightness -: Short press to decrease brightness.

Note: To reduce the power consumption of the remote control, it will enter sleep mode after 2 seconds and can be woken up by long pressing or double-clicking any button.

4. WLED Remote Control Connection Steps

1. Please ensure that the WLED controller version is 0.14.0-beta3 or above.
2. Please ensure that WLED Remote is in a good WIFI environment.
3. Go to the WLED controller's control page, click "Config" in the top right corner, select "WiFi Setup", scroll down to the bottom to find "Wireless Remote", check "Enable Remote", then click "Save & Connect".
4. Long press any button on the WLED remote for 1 second, then go to "WiFi Setup", find "Wireless Remote", copy the field after "Last Seen" to "Hardware MAC", then click "Save & Connect" to use the WLED remote control to control the WLED controller.

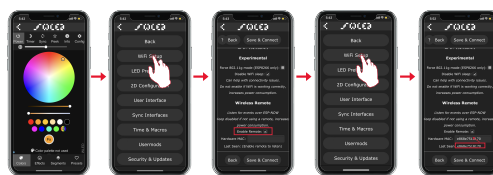

5. Preset Scenes

Go to the WLED control page, click "Presets" at the bottom, select "Preset", then click "Save".

Note: The saved Preset reflects the current status of the controller. Save to ID 1 is Scene 1, Save to ID 2 is Scene 2, and so on.

